



Aldreds
Estate Agents

2 Seamans Cottages Sidegate Road
Hopton, Great Yarmouth, NR31 9AS

£240,000



2 Seamans Cottages Sidegate Road

Hopton, Great Yarmouth, NR31 9AS

Sitting in this attractive semi rural location with fantastic views to front, driveway and a large rear garden, Aldreds are delighted to offer this spacious three storey, three bedroom mid terrace house. On the ground floor there is a lounge, study, lobby, bathroom and a large kitchen/diner. Oil central heating and double glazing.

Lounge

14'6" x 12'5" (4.44 x 3.8)

Door to front, double glazed window to front aspect, door to stairs to landing, radiator

Study

12'1" x 5'4" (3.7 x 1.63)

Kitchen/Diner

16'1" plus recess x 12'5" (4.92 plus recess x 3.8)

Base & wall units with worktops, door to garden double glazed window to rear aspect, sink with drainer, electric cooker point, sink with drainer

Lobby

Storage cupboard

Bathroom

6'4" x 5'3" (1.95 x 1.62)

Panel bath, hand basin, low level WC, part tiled walls, radiator

Landing

Stair to second floor

Bedroom 2

12'5" x 8'7" (3.8 x 2.64)

Double glazed window to front aspect, radiator

Bedroom 3

12'5" max 7'1" min x 10'9" max 5'1" min (3.8 max 2.17 min x 3.3 max 1.57 min)

Double glazed window to rear aspect, radiator

Landing





Bedroom 1

11'1" x 9'11" (3.4 x 3.04)

Double glazed window to front aspect, walk in cupboard

Outside

To the front there is a driveway. Large approx. west facing garden to rear with oil tank.

Tenure

Freehold

Services

Mains water, electricity, septic tank drainage

Council Tax

Band A

Location

Part of the beautiful south Norfolk coast, Hopton on Sea is a village and seaside resort found on east coast of Norfolk just 5 miles south of Great Yarmouth and 3 miles north of Lowestoft in Suffolk. Hopton-on-Sea is perhaps best known for being the host of the World Indoor Bowls Championships offering a well catered for tourist industry, visitors and locals alike can enjoy the village amenities which include leisure facilities, pubs and restaurants, primary school, village hall, church, post office and local shops. Bus links provide access to the Cathedral City of Norwich, Great Yarmouth and Lowestoft.

Directions

Leave Gorleston heading south on the A47, at the Links Road roundabout turn right towards Bradwell, at the next roundabout turn left and follow the road round to the right and back to the left and continue in to the countryside. The property is on the right.

Ref G18391/10/25

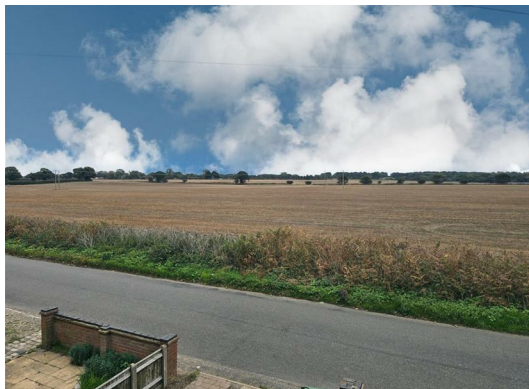

Floor Plan

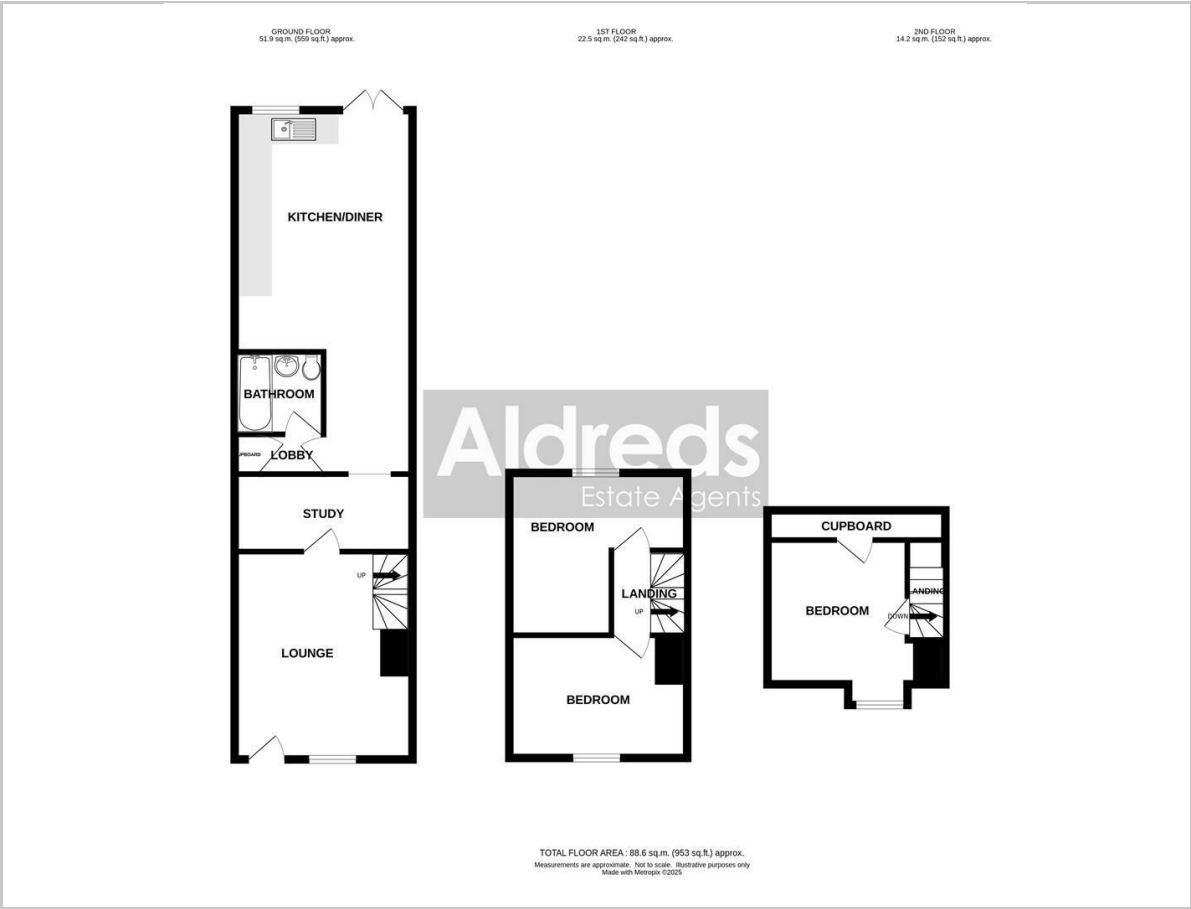

Area Map



Energy Efficiency Graph

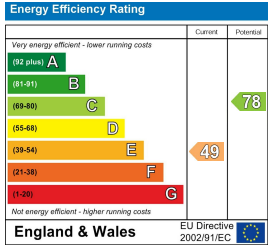

Viewing

Please contact our Aldreds Gorleston Office on 01493 664600 if you wish to arrange a viewing appointment for this property or require further information.

Disclaimer
These particulars are issued on an understanding that all negotiations shall be conducted through Messrs. Aldreds. Please note: Messrs. Aldreds for themselves and for the vendors or lessors of this property whose agents they are given notice that: 1. Particulars are set out as a general outline only for guidance of intending purchasers or lessees, and do not constitute nor constitute part of, an offer or contract. 2. All descriptions, dimensions, references to condition and necessary permissions for use and occupation, and other details are given without responsibility and any intending purchasers or tenants should not rely on them as statements or representations of fact but must satisfy themselves by inspection or otherwise as to the correctness of each of them. 3. No person in the employment of Messrs. Aldreds has any authority to make or give any representation or warranty whatever in relation to this property. 4. If you are proposing to visit the property and are travelling some distance please check with Aldreds on the issue of availability prior to travelling. 5. Aldreds Property Consultants and associated services may offer additional services to the prospective purchaser for which they will be entitled to receive a commission.
Aldreds are pleased to be working with Mortgage Advice Bureau. They're an award-winning mortgage broker with over 1,400 advisers across the UK, and have access to over 12,000 mortgage products from over 90 lenders. Aldreds Estate Agents Ltd receive a commission of £200 on each completed case. Your home may be repossessed if you do not keep up repayments on your mortgage. There may be a fee for mortgage advice. The actual amount you pay will depend upon your circumstances. The fee is up to 1%, but a typical fee is 0.3% of the amount borrowed. Mortgage Advice Bureau is a trading name of Mortgage Seeker Limited which is an appointed representative of Mortgage Advice Bureau Limited and Mortgage Advice Bureau (Derby) Limited which are authorised and regulated by the Financial Conduct Authority. Mortgage Seeker Limited Registered Office: Lovewell Blake, Sixty Six North Quay, Great Yarmouth, Norfolk, NR30 1HE. Registered in England Number: 03721415. 6. Potential purchasers should check with their providers that the broadband and mobile phone coverage they would require is available.

149 High Street, Gorleston, Norfolk, NR31 6RB
Tel: 01493 664600 Email: gorleston@aldreds.co.uk <https://www.aldreds.co.uk/>
Registered in England Reg. No. 08945751 Registered Office: 17 Hall Quay, Great Yarmouth, Norfolk NR30 1HJ
Directors: Mark Duffield B.S.c. FRICS. Dan Crawley MNAEA Paul Lambert MNAEA